

Flange Nyloc Insert Nut

Thread Type: Metric - Coarse

Thread Direction: Right Hand

Material: Stainless Steel

Class Grade: A2-70 G304

Corrosion Protection Level: Excellent

Standard: DIN 6926

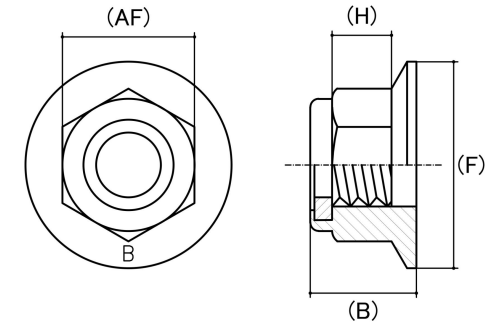

*CAD drawings shown for graphic representation only.**

Size	Thread Pitch (mm)	Thread Type	Overall Nut Height (B) (mm)		Hex Height (H) (mm)	Flange Diameter (F) (mm)	Flange Thickness (D) (mm)	Across Flats (AF) (mm)		Spanner Size (AF) (mm)	sku (qfind)
			Min	Max	Nom	Nom	Nom	Min	Max		
M3	0.50	Coarse	4.74	5.10	2.70	7.65	-	5.32	5.50	5.5	41FLNS3
M4	0.70	Coarse	5.74	6.10	3.00	10.10	-	6.78	7.00	7	41FLNS4
M5	0.80	Coarse	6.74	7.10	3.10	11.20	-	7.78	8.00	8	41FLNS5
M6	1.00	Coarse	8.74	9.10	3.10	14.20	2.00	9.78	10.00	10	41FLNS6
M8	1.25	Coarse	10.67	11.10	4.50	17.90	2.00	12.73	13.00	13	41FLNS8
M10	1.50	Coarse	13.30	13.60	5.50	21.80	2.26	14.73	15.00	15	41FLNS10
M12	1.75	Coarse	15.67	16.00	6.70	26.00	3.50	17.70	18.00	18	41FLNS12
M16	2.00	Coarse	19.46	20.00	9.00	34.50	4.50	23.67	24.00	24	41FLNS16

Disclaimer:

Dimensional data and technical information was obtained from publically available sources and not acquired through standard agencies. It has been completed and compiled for reference purposes only; where discrepancies are found they are subject to change without notice. Bolt & Nut Australia makes no warranties or representations regarding the accuracy and validity of the compiled information and data. Contact the relevant standard authorities for accurate and detailed information.

* CAD drawings may not reflect diameter, thread length or overall length.

© Bolt & Nut Australia Pty Ltd. All rights reserved.

Version: 18 Mar 2024